



SEATTec – SPECIAL VEHICLES





SEATTec – PASSENGERS SEATS

Ask us for technical specifications and complete data!

PUBLICO

(M2/M3)



ORBIS Co-Driver

M2



Orbis 200

(M2)

Midibus & Minibus



ORBIS SHARP

(M2)





SEATTec – PASSENGERS SEATS

Ask us for technical specifications and complete data!

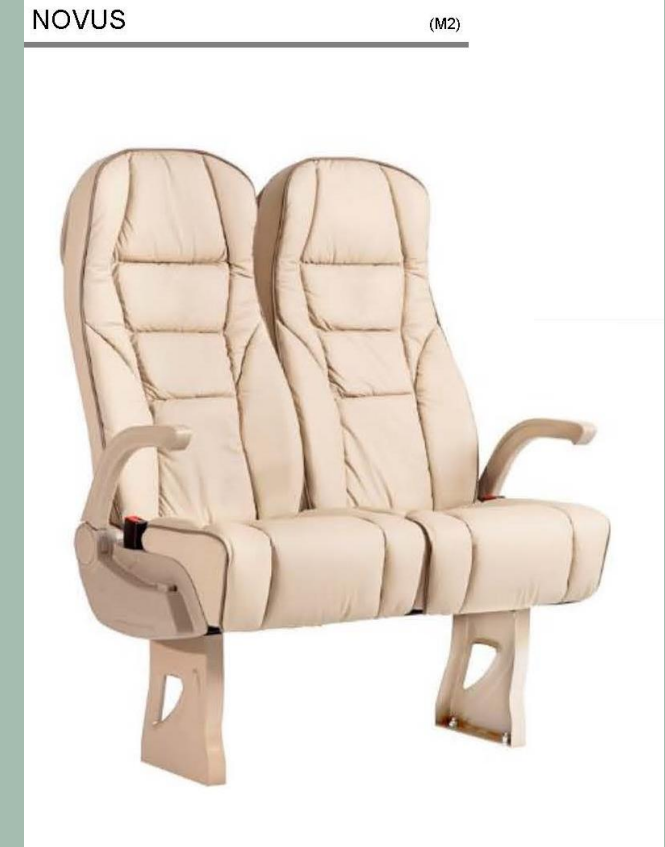
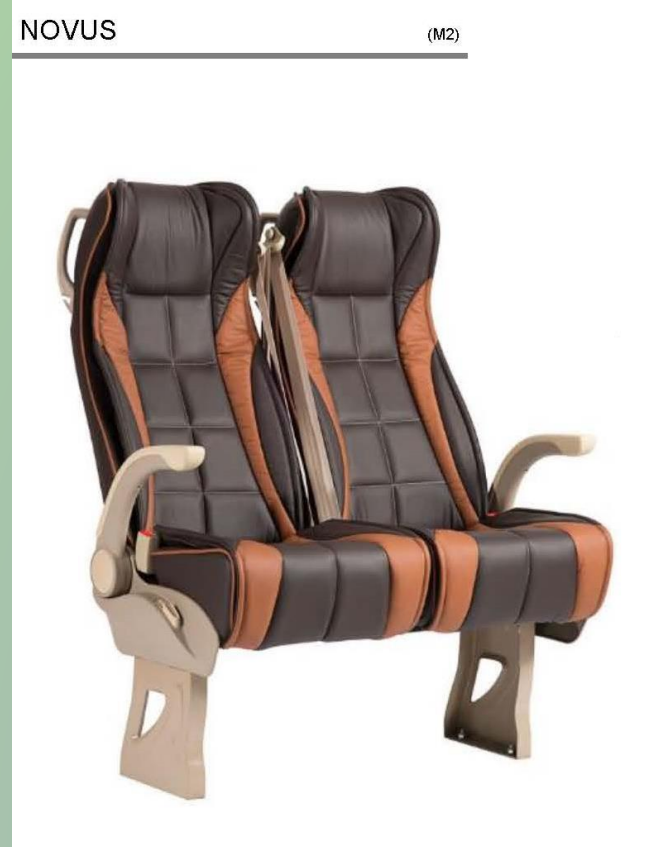
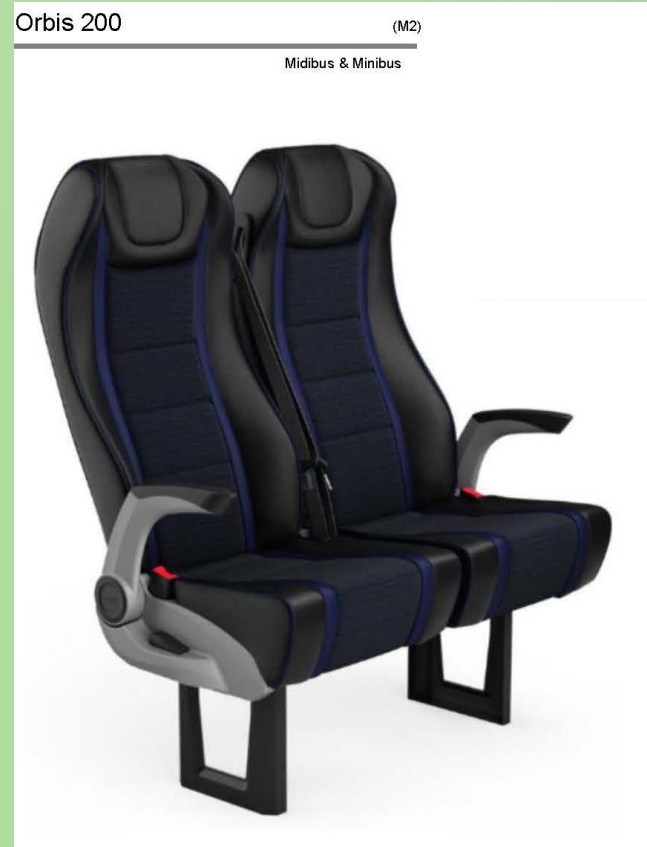



GLASSTec

WE CAN OFFER DIFFERENT VEHICLES GLASSES (MB SPRINTER, FORD TRANSIT, VW CRAFTER / MAN TGE, RENAULT MASTER, IVECO DAILY...

ALL CONFIGURATIONS, INCLUDING WINDOWS:

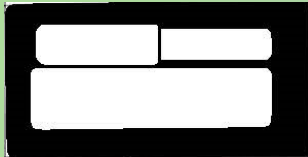
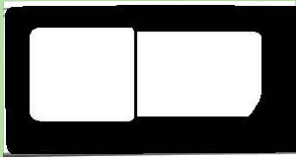

REAR GLASSES:



NOT HEATED

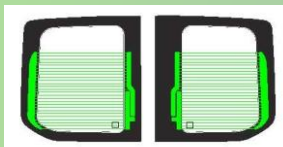

HEATED

FOR MB SPRINTER AND VW CRAFTER WE CAN PROVIDE DOUBLE GLASS 4-6-4 mm

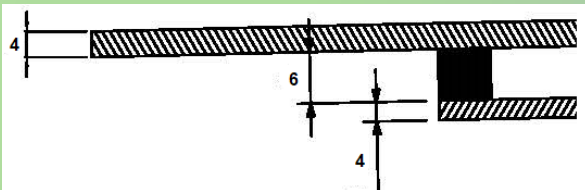

REV 1 March, 6th, 2025

© Alfred Mota Mancera



FORD TRANSIT



MERCEDES SPRINTER



VW CRAFTER

COLOURS: GALAXY, GREEN, GREY AND TRANSPARENT



ACCESSTec

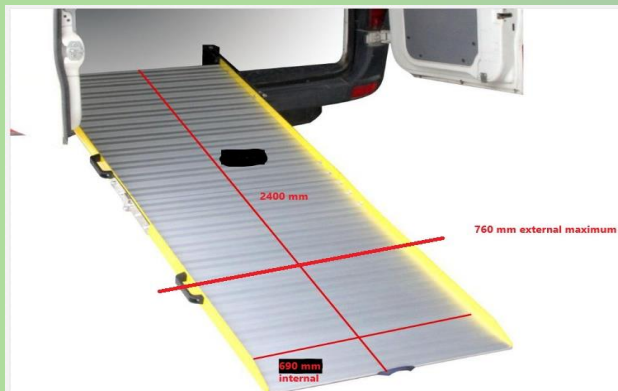

Pickpath series
Swing Steps

- * Corrugated anodised aluminium
- * Safe entrance thanks to antislip strips
- * All kind of mounting sets are available

ALUMINIUM 

Double steps are possible

Easy manual release



DIMENSIONS	A	B	C	D	E	F
PICKPATH SWING 450	455	452	180	220	183	260
PICKPATH SWING 500	520	518	180	220	183	260
PICKPATH SWING 550	550	548	180	220	183	260

* Dimensions are "mm"





INTERIOR Tec

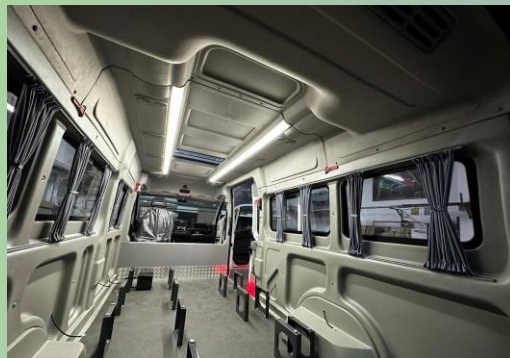
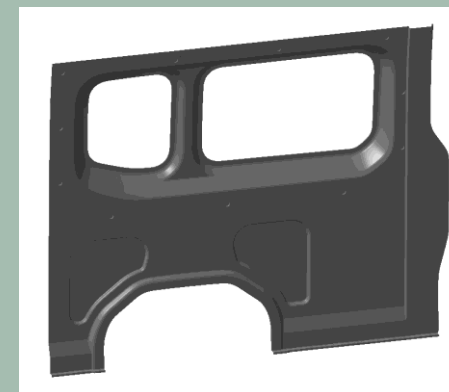
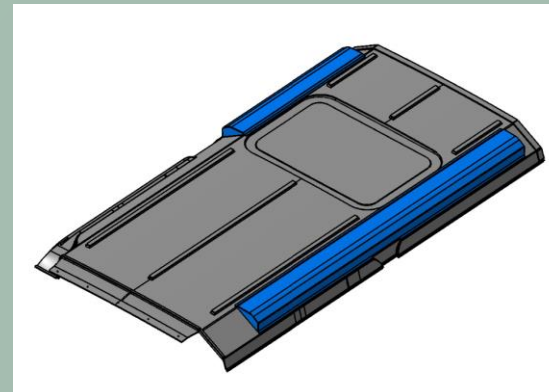
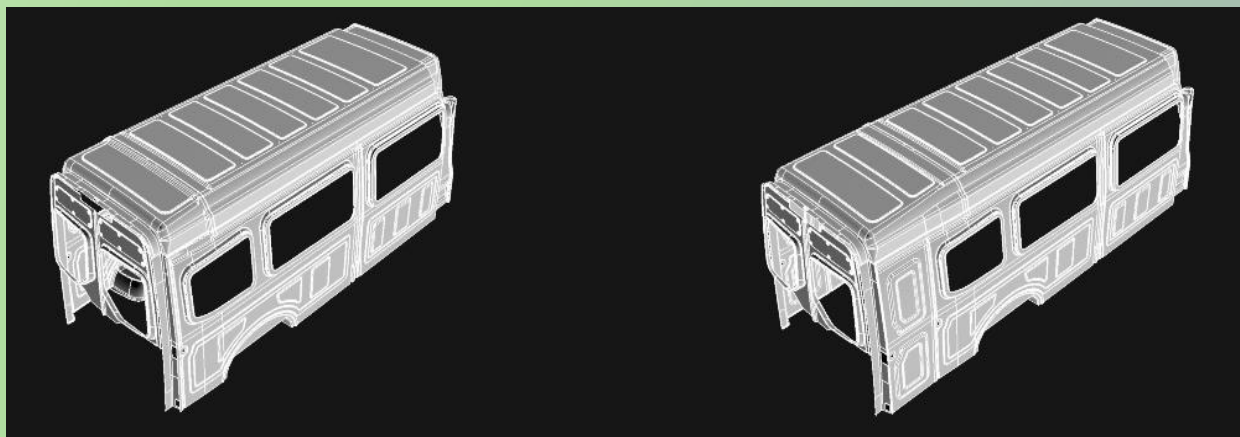

VEHICLES:
Renault Master XDD 2025
Fiat Ducato all models
MB Sprinter long and extra-long



LIGHTINGTec

Light Bar

Lighting Components



Main Features:

- Dimmer %70 - %100
- Voltage regulator
- Fixing by Screws or Adhesive
- ISO 16750 Standards
- LED Lighting Unit
- Supply Voltage 12V
- Operating Voltage: 9...16Vdc
- Light Color: White and Blue



Length (mm)	Voltage (DC)	White LED quantity	HUE	Blue LED quantity	Lux (at 30 cm)	Power Range	Weight (g.)
1031	12V/24V	72	5700K	24	800	9...16 VDC	440
1231	12V/24V	90	5700K	30	950	9...16 VDC	525
1531	12V/24V	108	5700K	36	1160	9...16 VDC	656
2031	12V/24V	144	5700K	48	1570	9...16 VDC	870
2231	12V/24V	165	5700K	55	1730	9...16 VDC	950
2931	12V/24V	216	5700K	72	2240	9...16 VDC	1250

LED Strip

Lighting Components

Main Features:

- Voltage regulator
- Dimmer-able by PWM
- Modular Lighting System (400mm, 500mm / pcs)
- Fixing by Screws or Adhesive
- Supply Voltage 12Vdc & 24Vdc
- Color Options for Main and Ambient Lighting
- ISO 16750 Standards
- Modular Solution
- Easy to Install
- Long Life
- Lower Power Absorption
- Temperature Resistant





LIGHTINGTec

LED Strip 6led White - 390x13mm

Lighting Components



Technical Data:

- Item 24Vdc
- Absorbed power at Full, 2712mW @ 24Vdc
- Absorbed power at Dimm, 1392mW @ 2Vdc
- Supply rated voltage, 24Vdc
- Input current (Full), 113mA
- Input current (Dimm), 58mA
- Operating Temperature Range -95 +100 °C
- Min. Luminous Flux > 126lm
- Luminous angle Led 120°
- Max q.ty of cascable mod. 20
- Led Lifetime e 40.000 hours
- Connection, TTAF

Safety:

- Reverse polarity, Diode
- Input protection, Diode
- Electric strength, Class II
- PCB, FR4

Light Efficiency:

Distance (m)	24Vdc (lm) White led
0.5	268
1	79,6
1.5	34
2	18,9

LED Strip 12led - 390x13mm

Lighting Components



Technical Data:

- Item 24Vdc
- Light Color temp. 6500K
- Absorbed power at Full 6,16W @ 28Vdc
- Absorbed power at Dimm 3,192W @ 28Vdc
- Supply rated voltage 24Vdc
- Input current (Full) 220mA
- Input current (Dimm) 114mA
- ta. Range temperature -40 +85 °C
- Typ. Luminous Flux > 960lm
- Luminous angle Led 120°
- Max q.ty of cascable mod. 20
- Led Lifetime e 40.000 hours
- Connection TTAF

Safety:

- Reverse polarity, Diode
- Input protection, Diode
- Electric strength, Class II
- PCB, FR4

Light Efficiency:

Distance (m)	24Vdc (lm) White led
0.5	748
1	232
1.5	124
2	80



LIGHTINGTec

LED Strip 12led - 300x16.5mm

Lighting Components



Technical Data:

- 24Vdc
- Light Color temp. 4000K
- Absorbed power at Full - 3,92W @ 28Vdc
- Supply rated voltage - 24Vdc
- Input current (Full) - 140mA @ 28Vdc
- ta. Range temperature -40 +85 °C
- Luminous angle Led 120°
- Led Lifetime 30.000 hours

Safety:

- Reverse polarity, Diode
- Input protection, Diode
- PCB, FR4

Light Efficiency:

Distance (m)	24Vdc (lux) White led
1	115 (no plastic diffuser)

USB type A Charger Module

Electronics Components



Main Features:

- Operating Voltage: 09Vdc – 30Vdc
- Operating Temperature: -40° +85°C
- LED Lighting: Blue, Green, Amber
- Output Voltage: 5V
- Output Current: 2x2,1A
- PA6 GF30 Body
- Hidden Screws Mounting
- Different LED colors available
- Short Circuit Protection
- Over-Heat Protection



New USB type C Charger Module

Electronics Components



- Supply Voltage : 8.2-32VDC Nominal Voltage : 12-24VDC
 - Operating Temperature : -40°C - +85°C
 - Support input over voltage and under voltage protection, support output short circuit, over current and over temperature protection
 - DP/DM/CC over voltage protection
 - DP/DM/CC withstand voltage of 30V
 - ESD 4KV, D.C withstand voltage of 40V
 - USB-C1 and USB-C2 PDO Output : 5V/3A, 9V/3A, 12V/2.25A, 3.3V-5.9V/3A, 5.3A-11V/3A
 - The output voltage and current is auto adjusted dynamically based on the fast charge requirement. USB Charger has a conversion efficiency of up to 96.5% when output 5V/3A.
 - USB-C1 and USB-C2 QC[1] Output : 5V/3.5A, 9V/2.25A, 12V/2A
- [1] QC: QC represents the output power of high voltage fast charge.
- Support 2 ports of Type-C PD output
 - Support 2 ports of BC1.2, IOS, Android
 - Support 2 ports of QC3.0 and QC2.0
 - Support 2 ports of MTK PE+2.0 and PE+ 1.1
 - Support 2 ports of FCP and SCP
 - Support 2 ports of fast charge: AFC
 - Support 2 ports of fast charge: VDOOC





LIGHTINGTec

New USB type C Flat Charger Module

Electronics Components

Main Features:

- ❑ Operating Voltage: 09Vdc – 30Vdc
- ❑ Operating Temperature: -40° -85 °C
- ❑ LED Lighting: Blue, Green, Amber
- ❑ Output Voltage: 5,9,12Vdc
- ❑ Output Current: 3(A), 1.6(A), 1.2(A)
- ❑ Over & Under Voltage protection
- ❑ Over-Heat Protection
- ❑ Class II Electric strength
- ❑ Designed to be installed on dashboards slots or on flat panels close to driver/passenger seats





COMPLETec



ALL KIND OF ACCESSORIES AND
ELEMENTS FOR THE FINISHES OF
YOUR VEHICLES TO GIVE THEM THEIR
OWN PERSONALITY